

Rainforest Coding

Activity Help Sheets

module 5

activity 14

The Mine (part 1)

1) You need to move the boxes of equipment to the grey robot. The mine robot can help as it will carry out special instruction when it touches a coloured background square.

1

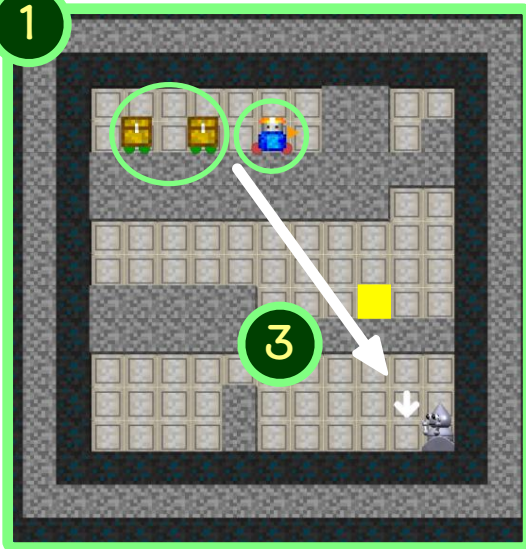

Level 1

2) Drag the special blocks inside the 'if touching color' block. To change a block, first remove it from the code line.

2

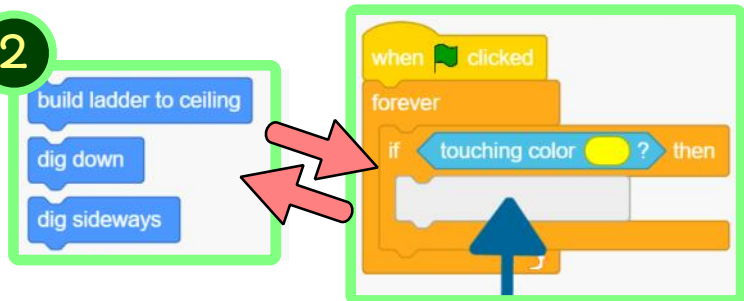

3) Click on the background squares to change them to yellow. If the mine robot touches the yellow square it will carry out the instructions inside the 'if touching color' block.

4

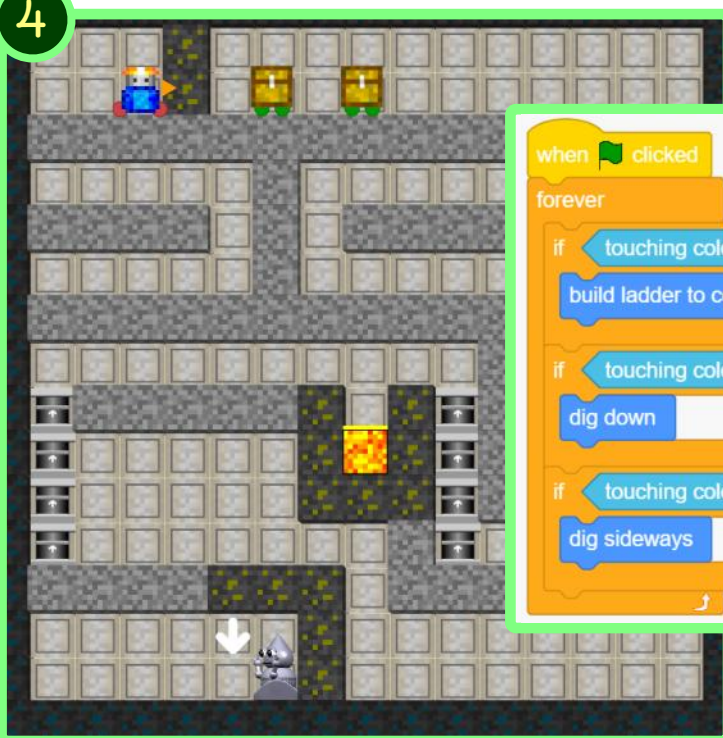

Level 2

4) There are three 'if touching color' blocks with the three special blocks inside.

Change the background colours to yellow, blue or red so the mine robot carries out the special instructions and the equipment boxes reach the grey robot.

Rainforest Coding

Activity Help Sheets

module 5

activity 13

The Mine Solutions (for the harder level 2)

